

L2000

4-TERMINAL PROBE

Instruction Manual

Oct. 2022 Revised edition 6
L2000A980-06 22-10H



www.hioki.com/



All regional contact information

HEADQUARTERS
HIOKI EUROPE GmbH
Helfmann-Park 2
Ueda, Nagano 386-1192 Japan
hioki@hioki.eu

Edited and published by HIOKI I.E. CORPORATION
2111 EN
Printed in Japan

- CE declarations of conformity can be downloaded from our website.
- Contents subject to change without notice.
- This document contains copyrighted content.
- It is prohibited to copy, reproduce, or modify the content of this document without permission.
- Company names, product names, etc., mentioned in this document are trademarks or registered trademarks of their respective companies.

Warranty

Warranty malfunctions occurring under conditions of normal use in conformity with the Instruction Manual and Product Precautionary Markings will be repaired free of charge. This warranty is valid for a period of one (1) year from the date of purchase. Please contact the distributor from which you purchased the product for further information on warranty provisions.

Introduction

Thank you for purchasing the Hioki L2000 4-Terminal Probe. To obtain maximum performance from the device, please read this manual first, and keep it handy for future reference.

Overview

The L2000 4-Terminal Probe allows lead parts and other measurement objects to be connected by cable and then measured. Various shaped parts can be measured with the four terminals.

Inspection and Maintenance

When you receive the device, inspect it carefully to ensure that no damage occurred during shipping. If damage is evident, or if it fails to operate according to the specifications, contact your dealer or Hioki representative.

Preliminary Checks

- Before using the device for the first time, verify that it operates normally to ensure that the no damage occurred during storage or shipping. If you find any damage, contact your dealer or Hioki representative.
- Before using the device, make sure that the insulation on the probes is undamaged and that no bare conductors are improperly exposed. Using the device in such conditions could cause an electric shock, so contact your dealer or Hioki representative for repair.

Maintenance and Service

- To clean the device, wipe it gently with a soft cloth moistened with water or mild detergent. Never use solvents such as benzene, alcohol, acetone, ether, ketones, thinners or gasoline, as they can deform and discolor the case.
- If the device seems to be malfunctioning, contact your dealer or Hioki representative. Pack the device so that it will not sustain damage during shipping, and include a description of existing damage. We do not take any responsibility for damage incurred during shipping.

Safety Information

This manual contains information and warnings essential for safe operation of the device and for maintaining it in safe operating condition. Before using it, be sure to carefully read the following safety precautions.

⚠ DANGER

This device is designed to comply with IEC 61010 Safety Standards, and has been thoroughly tested for safety prior to shipment. However, mishandling during use could result in injury or death, as well as damage to the device. However, using the device in a way not described in this manual may negate the provided safety features.

Be certain that you understand the instructions and precautions in the manual before use. We disclaim any responsibility for accidents or injuries not resulting directly from device defects.

⚠ DANGER	Imminent risk of operator death or serious injury
⚠ WARNING	Potential for operator death or serious injury
⚠ CAUTION	Potential for minor operator injury or instrument damage or malfunction
🚫	Indicates the prohibited action.
📢	Indicates the compulsory action.

Symbols Affixed to the Instrument

⚠	Precaution or hazard (See corresponding topic.).
⚡	DC (Direct Current).

Specifications

Measurable frequency range	DC to 8 MHz (depending on the frequency of the instrument to be connected.)
Maximum rated voltage	±42 Vpeak (AC+DC)
Maximum rated current	±1 Apeak (AC+DC)
Measurable terminal diameter	5 mm (0.20") or less
Overall length	Approx. 1000 mm (39.37") (excluding connection terminals)
Mass	Approx. 315 g (11.1 oz.)
Cable used	50 Ω coaxial cable
Structure	4-terminal-pair structure
Terminal processing	Gold-plated
Operating temperature and humidity	0°C to 40°C (32 to 104°F), 80%(RH) or less (non-condensing)
Storage temperature and humidity	-10°C to 50°C (14 to 122°F), 80%(RH) or less (non-condensing)
Operating environment	Indoors, Pollution degree 2, altitude up to 2000 m (6562 ft.)
Product warranty period	1 year Connector, cable, etc.: Not covered by the warranty

Specifications

Follow these precautions to ensure safe operation and to obtain the full benefits of the various functions.

Instrument Installation

⚠ WARNING

Installing the device in inappropriate locations may cause a malfunction of the device or may give rise to an accident. Avoid the following locations:

- Exposed to direct sunlight, exposed to high temperature
- In the presence of corrosive or explosive gases
- Exposed to strong electromagnetic fields, near electromagnetic radiator
- Near induction heating systems (e.g., highfrequency induction heating systems and IH cooking utensils)
- Subject to vibration
- Exposed to water, oil, other chemicals, or solvents
- Exposed to high humidity or condensation
- Exposed to high levels of particulate dust

⚠ DANGER

To avoid electric shock, do not remove the device's case. The internal components of the device carry high voltages and may become very hot during operation.

⚠ WARNING

Do not attempt to modify, disassemble or repair the device; as fire, electric shock and injury could result.

⚠ CAUTION

- Do not slant the device or place it on top of an uneven surface. Dropping or knocking down the device can cause injury or damage to the device.
- To avoid damage to the device, protect it from physical shock when transporting and handling. Be especially careful to avoid physical shock from dropping.
- Keep the cables well away from heat sources, as bare conductors could be exposed if the insulation melts.

For details on a device to be connected, refer to the instruction manual of the device to be connected.

Names of Parts

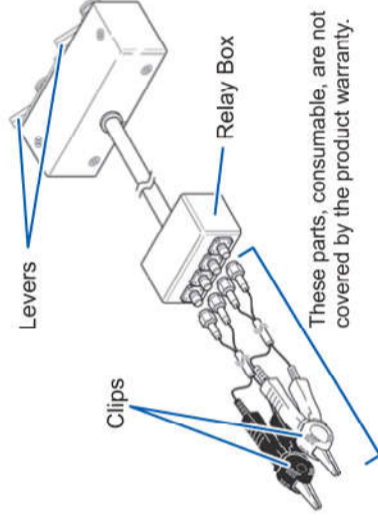

These parts, consumable, are not covered by the product warranty.

Connection

With the surface on which the model name is printed facing up, connect the test fixture directly to the measurement terminals (UNKOWN terminals) of the device to be connected, and then secure the test fixture in position with the levers on the left and right.

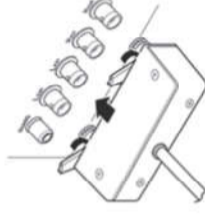

Specifications

Perform open and short compensation to increase the measurement accuracy.

Open compensation procedure

Create an open state between HIGH and LOW, and then perform open compensation.

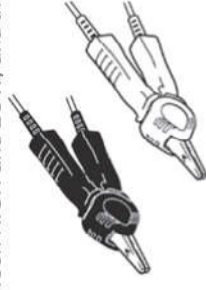

Allow the same space between HIGH and LOW as for a test sample.

Short compensation procedure

Short-circuit the terminals with the V marks on the clips aligned as shown in the diagram, and then perform short compensation.

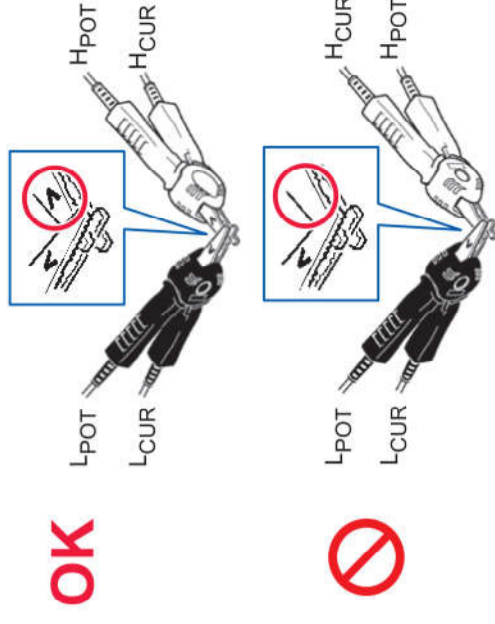

For the detailed operating procedure, refer to the instruction manual of the device to be connected.

Measurement Procedure

Clamp the clips at the tips of the probes onto the test sample and then perform measurement.

Measurement example

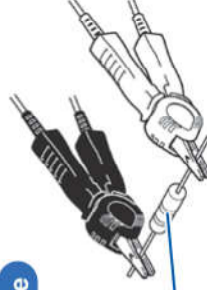

- Note that dirt on the contact surfaces of the electrodes and test sample may result in a poor contact and the inability to perform measurement accurately.

- Open compensation and measurement of high impedance elements are susceptible to the influence of externally induced noise and stray capacitance, so we recommend using guarding; for example, connecting a metal plate to the GUARD terminal and carrying out the compensation or measurement on the metal plate. (For details on guarding, refer to the instruction manual of the connected device.)
- The probe tips are connected to the relay box by SMA connectors, so correct measurement may not be possible if the SMA connectors are not securely connected or if the wiring is incorrect.

